

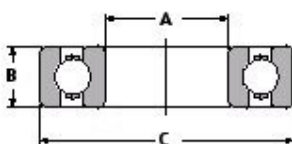

ROULEMENTS RIGIDES À BILLES



1 RANGÉE série 6000-6200-6300

LL= étanchéité plastique

SÉRIE			DIFFUMAG	A (mm)	B (mm)	C (mm)
6000	6200	6300				
6000LL			8090	10	8	26
	6200LL		8188		9	30
6001LL			8096	12	8	28
	6201LL		8196		10	32
		6301LL	8296	15	12	37
6002LL			8102		9	32
	6202LL		8202	17	11	35
		6302LL	8302		13	42
6003LL			8109	20	10	35
	6203LL		8209		12	40
		6303LL	8309	25	14	47
6004LL			8115		12	42
	6204LL		8215	30	14	47
		6304LL	8315		15	52
6005LL			8121	35	12	47
	6205LL		8221		15	52
		6305LL	8321	40	17	62
6006LL			8127		13	55
	6206LL		8227	45	16	62
		6306LL	8327		19	72
6007LL			8133	50	14	62
	6207LL		8233		17	72
		6307LL	8333	55	21	80
6008LL			8139		15	68
	6208LL		8239	60	18	80
		6308LL	8339		23	90
6009LL			8145	65	16	75
	6209LL		8245		19	85
		6309LL	8345	70	25	100
6010LL			8151		16	80
	6210LL		8251	75	20	90
		6310LL	8351		27	110
6011LL				80	18	90
	6211LL		8255		21	100
		6311LL		85	29	120
6012LL			8155		18	95
	6212LL		8264	90	22	110
		6312LL			31	130

ROULEMENTS RIGIDES À BILLES

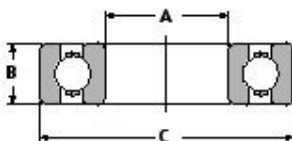

1 RANGÉE série 6000-6200-6300

ZZ= étanchéité métallique



SÉRIE			DIFFUMAG	A (mm)	B (mm)	C (mm)
6000	6200	6300				
6001ZZ			8097	12	8	28
	6201ZZ		8197		10	32
		6301ZZ	8297		12	37
6002ZZ			8103	15	9	32
	6202ZZ		8203		11	35
		6302ZZ	8303		13	42
6003ZZ			8110	17	10	32
	6203ZZ		8210		12	40
		6303ZZ	8310		14	47
6004ZZ			8116	20	12	42
	6204ZZ		8216		14	47
		6304ZZ	8316		15	52
6005ZZ			8122	25	12	47
	6205ZZ		8222		15	52
		6305ZZ	8322		17	62
6006ZZ			8128	30	13	55
	6206ZZ		8228		16	62
		6306ZZ	8328		19	72
6007ZZ			8134	35	14	62
	6207ZZ		8234		17	72
		6307ZZ	8334		21	80
6008ZZ			8140	40	15	68
	6208ZZ		8240		18	80
		6308ZZ	8340		23	90
6009ZZ			8146	45	16	75
	6209ZZ		8246		19	85
		6309ZZ	8346		25	100
6010ZZ			8152	50	16	80
	6210ZZ		8252		20	90
		6310ZZ	8352		27	110
6011ZZ				55	18	90
	6211ZZ				21	100
		6311ZZ			29	120
6012ZZ			8156	60	18	95
	6212ZZ				22	110
		6312ZZ			31	130

For New Technology Network

NTN®



ROULEMENTS RIGIDES À BILLES

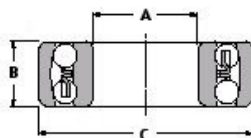

**2 RANGÉES alésage cylindrique
série 1200-1300**

SÉRIE		DIFFUMAG	A (mm)	B (mm)	C (mm)
1200	1300				
1206		8018	30	16	62
	1306	8019		19	72
1207		8020	35	17	72
	1307	8022		21	80
1208		8023	40	18	80
	1308	8025		23	90
1209		8026	45	19	85
	1309	8028		25	100
1210		8029	50	20	90
	1310	8031		27	110

For New Technology Network

NTN®



ROULEMENTS RIGIDES À BILLES

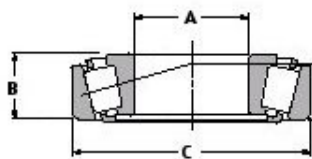

**alésage conique
série 30200-30300**



SÉRIE		DIFFUMAG	A (mm)	B (mm)	C (mm)
30200	30300				
30203		8051	17	13,25	40
	30303	8070		15,25	47
30204		8052	20	15,25	47
	30304	8071		16,25	52
30205		8053	25	16,25	52
	30305	8072		18,25	62
30206		8054	30	17,25	62
	30306	8073		20,75	72
30207		8055	35	18,25	72
	30307	8074		22,75	82
30208		8056	40	19,75	80
	30308	8075		25,25	90
30209		8057	45	20,75	85
	30309	8076		27,25	100
30210		8058	50	21,75	90
	30310	8077		29,25	110

série 32200-32300

SÉRIE		DIFFUMAG	A (mm)	B (mm)	C (mm)
32200	32300				
32204		8079	20	19,25	47
32205		8080	25	19,25	52
	32305	8085		22	52
32206		8081	30	21,25	62
	32306	8086		25	62
32207		8082	35	24,25	72
	32307	8087		28	72
32208		8083	40	24,75	80
	32308	8088		32	80
32209		8084	45	24,75	85
	32309	8092		32	85



ROULEMENTS ET PALIERS auto-aligneurs

NTN

PALIERS

Livré avec roulement

type UCF

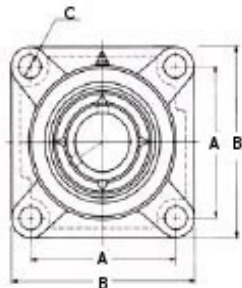

TYPE	DIFFUMAG	A (mm)	B (mm)	C (mm)	Ø ROULEMENT
UCF204	8501	64	86	12	20
UCF205	8502	70	95		25
UCF206	8503	83	108		30
UCF207	8504	92	117	14	35
UCF208	8505	102	130	16	40
UCF209	8506	105	137		45
UCF210	8507	111	143		50

type UCP

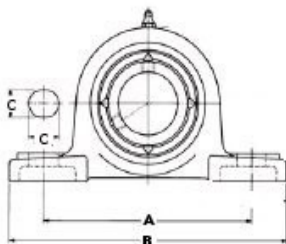

TYPE	DIFFUMAG	A (mm)	B (mm)	C (mm)	Ø ROULEMENT
UCP205	8521	105	140	13/19	25
UCP206	8522	121	165	17/21	30
UCP207	8523	127	167		35
UCP208	8524	137	184	17/23	40
UCP209	8525	146	190		45

type UCFL

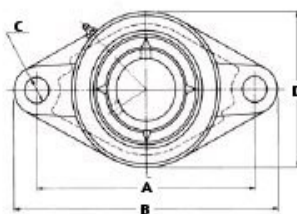

TYPE	DIFFUMAG	A (mm)	B (mm)	C (mm)	D (mm)	Ø ROULEMENT
UCFL205	8511	99	130	16	68	25
UCFL206	8512	117	148		80	30
UCFL207	8513	130	161		90	35
UCFL208	8514	144	175		100	40
UCFL209	8515	148	188	19	108	45

ROULEMENTS ET PALIERS auto-aligneurs

NTN

ROULEMENTS

TYPE AEL (YET)
BAGUE EXCENTRIQUE

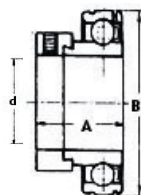

TYPE	DIFFUMAG	A (mm)	B (mm)	d (mm)
YET204	8161	31	47	20
YET205	8541	31	52	25
YET206	8542	35,7	62	30
YET207	8543	38,9	72	35
YET208	8544	43,7	80	40
YET209	8545	43,7	85	45
YET210	8546	43,7	90	50

TYPE UC(YAR)
VIS DE BLOCAGE

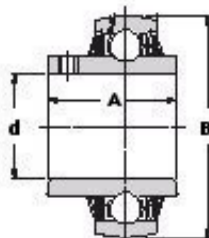

TYPE	DIFFUMAG	A (mm)	B (mm)	d (mm)
YAR205	8535	34	52	25
YAR206	8536	38,1	62	30
YAR207	8537	42,9	72	35
YAR208	8538	49,2	80	40
YAR209	8539	49,2	85	45
YAR210	8540	51,6	90	50

ROULEMENTS RIGIDE À BILLES

1 rangée de bille - étanche plastique



CMW origine								
SÉRIE 6000			SÉRIE 6200			SÉRIE 6300		
TYPE	Réf.	Dim. Int.xExt.xÉp.	TYPE	Réf.	Dim. Int.xExt.xÉp.	TYPE	Réf.	Dim. Int.xExt.xÉp.
6001 2RS	8096CMW	12x28x8	-	-	-	-	-	-
6002 2RS	8102CMW	15x32x9	6202 2RS	8202CMW	15x35x11	6302 2RS	8302CMW	15x42x13
6003 2RS	8109CMW	17x35x10	6203 2RS	8209CMW	17x40x12	6303 2RS	8309CMW	17x47x14
6004 2RS	8115CMW	20x42x12	6204 2RS	8215CMW	20x47x14	6304 2RS	8315CMW	20x52x15
6005 2RS	8121CMW	25x47x12	6205 2RS	8221CMW	25x52x15	6305 2RS	8321CMW	25x62x17
6006 2RS	8127CMW	30x55x13	6206 2RS	8227CMW	30x62x16	6306 2RS	8327CMW	30x72x19
6007 2RS	8133CMW	35x62x14	6207 2RS	8233CMW	35x72x17	6307 2RS	8333CMW	35x80x21
6008 2RS	8139CMW	40x68x15	6208 2RS	8239CMW	40x80x18	6308 2RS	8339CMW	40x90x23
6009 2RS	8145CMW	45x75x16	6209 2RS	8245CMW	45x85x19	6309 2RS	8345CMW	45x100x25
6010 2RS	8151CMW	50x80x16	6210 2RS	8251CMW	50x90x20	6310 2RS	8351CMW	50x110x27

PALIER COMPLETS

avec vis de blocage

CMW origine								
SÉRIE UCF (applique 4 trous)			SÉRIE UCFL (applique 2 trous)			SÉRIE UCP (semelle)		
TYPE	Réf.	ø int.	TYPE	Réf.	ø int.	TYPE	Réf.	ø int.
UCF204	8501CMW	20	UCFL204	8510CMW	20	UCP204	8520CMW	20
UCF205	8502CMW	25	UCFL205	8511CMW	25	UCP205	8521CMW	25
UCF206	8503CMW	30	UCFL206	8512CMW	30	UCP206	8522CMW	30
UCF207	8504CMW	35	UCFL207	8513CMW	35	UCP207	8523CMW	35
UCF208	8505CMW	40	UCFL208	8514CMW	40	UCP208	8524CMW	40
UCF209	8506CMW	45	UCFL209	8515CMW	45	UCP209	8525CMW	45
UCF210	8507CMW	50	UCFL210	8516CMW	50	UCP210	8526CMW	50



UCF - applique 4 trous



UCFL - applique 2 trous



UCP - à semelle

FILTRES

MAHLE



MAHLE	DIFFUMAG	CORRESPONDANCE	
		MANN	FLEETGUARD
HC12	8890	W962/15	HF6267
KC1	8850	W723/1	FF4136
KC4	8847	WK1168	FF5039
KC7	8848	WK962/4	FF4070
KC17	8841	WK842	FF5156
KC18	8879	WK842/2	FF5135
KC20	8837	WK712/2	FF5040
KC24	8838	WK723	FF5018
KX2	8843	-	FF145
KX6	8886	-	FF5054
KX13	8842	P78X	FF5050
KX14	8884	P710	-
KX20	8846	P923/1X	FF145
KX21	8830	P810X	FF144
KX23	8836	P917X	FF167
KX24	8840	P945X	FF4052A
KX25	8831	P824X	FF5364
KX34	8834	P715	FF230
KX35	8844	P707	FF146
KX36	8833	P811	FF147
KX43	8832	BF707	FF5053
KX44	8851	BF811	FF5054
KX51	8835	P833	FF5197
LX14	8859	C1188	AF435KM
LX15	8860	C12114	AF492
LX16	8861	C14179	AF437K
LX17	8868	C16190	AF409K
LX18	8862	C16302	AF4059K
LX21	8870	C24516	AF353K
LX28	8872	C24179	AF418
LX33	8873	C18436	AF1735K
LX196	8863	C17134	AF4137
LX200	8864	C13114/4	AF4067
LX227	8897	C23440/1	A25065
LX229	8898	C23440	AF971
LX236	8865	C17224/3	AF4058
LX242	8899	C17225	AF1801
LX265	8866	C20325/2	AF25044M
LX271	8900	C24650/1	AF4060
LX272	8901	C1176/3	AF4066

FILTRES

MAHLE



MAHLE	DIFFUMAG	CORRESPONDANCE	
		MANN	FLEETGUARD
LX275	8867	C15175/3	AF4135
LXS5/1	8904	CF700	AF4522
LXS37/1	8905	CF1000	AF1840
LXS41/1	8907	CF800	AF1842
LXS42/1	8908	CF1200	AF1841
LXS43/1	8909	CF1300	AF1843
LXS61	8910	CF711	AF25490
LXS201	8911	C1281	AF490M
LXS212	8912	CF923	AF988
LXS214	8913	CF922	AF4103
OC8	8889	W719/11	LF742
OC11	8964	W77	LF3826
OC15	8816	W1140	LF682
OC18	8814	W920/21	LF3400
OC24	8857	W77	LF3675
OC26	8812	W940/5	LF4056
OC29	8887	W950/5	LF699
OC31	8965	W920/23	LF3377
OC34	8855	W818/2	LF700
OC35	8858	W1170	LF3346
OC37	8820	W940/24	LF701
OC38	8819	W723/3	LF700
OC40	8893	W11102	LF4112
OC42	8817	W950/7	LF699
OC47	8966	W719/5	LF3568
OC51	8967	W940/25	LF3451
OC59	8827	W940	LF3402
OC60	8818	W962	LF4054
OC62	8813	W930	LF742
OC67	8809	W940/1	LF3313
OC72	8891	W929/2	-
OC83	8828	W920/21	LF3376
OC88	8892	W940/37	LF3315
OC98	8829	W815/3	-
OC99	8856	W712/8	LF3624
OC103	8811	W936/4	LF632B
OC133	8968	W1126	LF3400
OC223	8969	W920/47	LF3714
OX5	8826	H12105X	HF6118
OX9	8825	H939	-

FILTRES

MAHLE



MAHLE	DIFFUMAG	CORRESPONDANCE	
		MANN	FLEETGUARD
OX14	8806	H1029/1n	LF599
OX16	8805	H1018/2n	LF4001
OX17	8802	H804T	LF566
OX18	8804	H820/3X	LF596
OX20	8895	H813/1n	LF633
OX31	8824	H943/2T	LF4081
OX43	8854	H932/2T	LF756
OX47D	8852	H720X	LF779
OX50	8801	H827/1n	LF594
OX51	8807	H1038	LF598
OX55	8876	H1060N	LF4081
OX58	8881	H1034	LF598
OX60	8875	H928/1	LF552
OX82	8803	PF815	-
OX86	8808	H1260X	LF550

**Pour d'autres références de la gamme MAHLE,
n'hésitez pas à nous consulter.**

Tél 03 88 55 57 02



FILTRES

MANN



MANN	DIFFUMAG	CORRESPONDANCE	
		FLEETGUARD	MAHLE
C12114	10656	AF492	LX15
C12114/1	10703	AF4568	-
C12116/1	10657	AF461	-
C13114/4	10658	AF4067	LX200
C14179	10659	AF437K	LX16
C14179/1	10660	AF1830KM	-
C14190	10661	AF940K	LX32
C15165/3	10662	AF4135	LX52
C15300	10704	AF25565	-
C16335	10663	-	-
C17134	10705	AF4137	LX196
C17160	10664	AF4637	-
C17225/3	10665	AF4058	LX236
C17250	10666	AF991	-
C17278	10707	AF25296	-
C17400	10667	AF1641	-
C1760	10701	-	LX123
C19384	10668	AF25300	-
C20500	10669	AF25723	-
C23589	10670	AF25341	-
C24523	10671	-	-
C24719	10672	AF418	LX28
C24725	10673	AF947	-
C24752	10674	AF2538	-
CF300	10710	AF25566	-
H1018/2N	10719	LF4001	OX16
H1038	10717	LF598	OX51
H1038X	10718	LF598	OX15
H12110/2X	10723	LF3327	OX69D
H1265	10720	-	-
H1275X	10721	LF33270	OX71D
H1292/1	10722	-	HX13
H720X	10714	LF779	OX47D
H820/3X	10715	LF596	OX18
HU942/2X	10899	-	-
P707	10731	FF146	KX35
P716	10903	HF6168	-
P824X	10732	FF5364	KX25
P917X	10733	FF167	KX23
W11102	10775	LF4112	OC40



FILTRES

MANN



MANN	DIFFUMAG	CORRESPONDANCE	
		FLEETGUARD	MAHLE
W1130	10771	LF3770	OC86
W1140	10772	LF682	OC15
W13145/3	10783	LF3493	-
W712/31	10744	LF3678	-
W712/4	10742	-	-
W712/43	10745	-	-
W712/8	10743	LF3624	OC99
W713/18	10904	-	-
W716/1	10902	LF3624	-
W719/4	10753	LF785	-
W719/5	10746	LF3568	OC47
W723/3	10747	LF700	OC38
W77	10741	LF3826	OC11
W8005	10774	LF3347	OC14
W815/3	10905	-	OC98
W818/2	10749	LF700	OC34
W914/2	10748	LF3376	OC4
W920	10777	LF3378	OC63
W920/21	10751	LF3376	OC18
W920/23	10752	LF3377	OC31
W920/7	10750	LF3376	OC83
W930	10754	LF742	OC62
W930/7	10778	LF742	OC80
W963/4	10755	LF632B	OC103
W940	10756	LF3402	OC59
W940/18	10759	LF4056	OC26
W940/24	10760	LF701	OC37
W940/25	10761	LF3451	OC51
W940/34	10762	LF3345	-
W940/5	10757	-	OC26
W940/81	10763	LF551A	OC67
W950	10779	LF4154	OC27
W950/17	10766	LF3331	-
W950/18	10782	LF3349	-
W950/4	10764	LF3580	OC105
W950/5	10780	LF699	OC29
W950/7	10765	LF699	OC42
W962	10767	LF4054	OC60
W962/15	10770	HF6267	HC12
W962/2	10768	LF3413	OC48



FILTRES

MANN



MANN	DIFFUMAG	CORRESPONDANCE	
		FLEETGUARD	MAHLE
W962/6	10769	LF3625	-
WDK940/5	10798	FF598	-
WK42/1	10786	FF149	-
WK614/1	10787	-	-
WK712/2	10788	FF5040	KC20
WK731	10789	FF5018	KC6
WK828	10792	-	-
WK842	10790	FF5156	-
WK842/1	10906	FF5135	-
WK842/2	10791	FF5135	KC18
WP1144	10796	LF3481	-
C2295	C2295	-	-
C30154	C30154	-	-
C60148	C60148	AF4643	-
H618	H618	-	-
H724/1	H724/1	-	-
H827/1X	H827/1X	-	-
H827/1N	H827/1N	LF594	OX50
H939	H939		OX9
P811	FF147	FF147	KX36
P945X	P945X	FF4052A	KX24
PF1190X	PF1190X	LF3391	OX30D
W814/80	W814/80	LF3536	OC115
WD950/2	WD950/2	HF28989	-
WD950/4	WD950/4	-	-
WK719/5	WK719/5	FF5163	-
WK723	WK723	FF5074	KC24
WK814/1	WK814/1	FF5112	KC22
W940/5	W940/5	FF231	-

**Pour d'autres références de la gamme MANN,
n'hésitez pas à nous consulter.**

Tél 03 88 55 57 02



FILTRES FLEETGUARD



FLEETGUARD	DIFFUMAG	CORRESPONDANCE	
		MAHLE	MANN
AF409K	10801	LX17	C16190
AF437K	10802	LX16	C14179
AF492	10803	LX15	C12114
AF906	10804	-	-
AF907	10805	-	-
AF971	10806	LX229	C23440
AF990	10807	LX99	C17201
AF991	10808	-	C17250
AF1640	10809	-	-
AF1641	10810	-	C17400
AF1733K	10892	LX18	C16302
AF1801	10811	LX242	C17225
AF1802	10812	LX273	C30850/2
AF1830KM	10813	-	C14179/1
AF1840	10814	LXS37	CF1000
AF1841	10815	LXS42	CF1200
AF1842	10816	LXS41	CF800
AF1843	10817	LXS43	CF1300
AF1855	10818	-	-
AF4058	10819	LX236	C17225/3
AF4060	10820	LX271	C24650/1
AF4067	10821	LX200	C13114/4
AF4103	10893	LXS214	CF922
AF4135	10822	LX275	C15165/3
AF4137	10823	LX196	C17134
AF4500	10824	-	-
AF4501	10825	-	-
AF4511	10826	-	-
AF4521	10827	-	CF600
AF4522	10828	-	CF700
AF4523	10829	-	CF1600
AF4564KM	10830	-	C16334
AF4565	10831	-	-
AF4566	10832	-	-
AF4655KM	10833	-	-
AF4761M	10834	-	-
AF4856M	10835	-	C18267
AF4878	10836	-	C24523
AF4891M	10837	-	-
AF4905M	10838	-	-



FILTRES FLEETGUARD



FLEETGUARD	DIFFUMAG	CORRESPONDANCE	
		MAHLE	MANN
AF4980KM	10839	-	-
AF4981M	10840	-	-
AF4994	10841	-	-
AF25002M	10842	-	-
AF25057	10843	-	-
AF25062	10844	-	C33920/3
AF25064	10845	-	C20325/2
AF25065	10846	-	C23440/1
AF25215	10847	-	C2791
AF25228M	10848	-	-
AF25229M	10849	-	-
AF25230	10850	-	CF2100
AF25290	10851	-	C11103
AF25291	10852	-	C14200/1
AF25292	10853	-	-
AF25300	10854	-	C19384
AF25301	10855	-	C1342
AF25302	10856	-	-
AF25303	10857	-	-
AF25323	10858	-	C18180/1
AF25324K	10859	-	C16150
AF25331	10860	-	-
AF25334	10861	-	C1374/2
AF25336	10862	-	-
AF25341	10863	-	C23589
AF25342	10864	-	-
AF25343	10865	-	-
AF25344	10866	-	-
AF25349	10867	-	-
AF25352	10868	-	C17337
AF25356	10869	-	CF961
AF25357	10870	-	-
AF25358	10871	-	-
AF25359	10872	-	-
AF25360	10873	-	-
AF25361	10874	-	C13114/8
AF25368	10875	-	-
AF25371	10876	-	-
AF25424	10877	-	CF821
AF25425	10878	-	CF830



FILTRES FLEETGUARD



FLEETGUARD	DIFFUMAG	CORRESPONDANCE	
		MAHLE	MANN
AF25434	10879	-	CF620
AF25457	10880	-	-
AF25484	10881	-	CF850
AF25485	10882	-	CF990
AF25490	10883	-	-
AF25491	10884	-	CF1140
AF25492	10885	-	C21630/1
AF25498	10886	-	-
AF25499	10887	-	-
AF25501	10888	-	-
AF25502K	10889	-	-
AF25503	10890	-	-
AF25504	10891	-	-
FF167	10989	KX23	P917X
FF167A	10988	-	P917X
FF201	10898	KC27	-
FF4052A	10950	KX24	P945X
FF5018	10923	KC6	WK731
FF5039	10944	KC4	WK1168
FF5045	10957	-	-
FF5052	10954	-	WK731
FF5095	10945	-	WK731
FF5117	10958	-	WK842/6
FF5135	10925	-	WK842/2
FF5156	10924	-	WK842
FF5320	10895	-	-
FF5364	10922	-	-
FS1280	10933	-	-
FS1287	10943	-	-
FS19504	10959	-	-
FS19516	10960	-	-
FS19517	10930	-	-
FS19531	10961	-	-
FS19585	10962	-	-
FS19588	10955	-	-
HF28808	10917	-	-
HF28812	10981	-	-
HF28813	10936	-	-
HF28818	10982	-	WD950/5
HF28833	10983	-	-



FLEETGUARD	DIFFUMAG	CORRESPONDANCE	
		MAHLE	MANN
HF28857	10984	-	-
HF28881	10985	-	-
HF28934	10986	-	-
HF28935	10937	-	-
HF6079	10928	-	H1263/1
HF6143	10897	-	-
HF6177	10934	HC4	W1374/2
HF6184	10977	-	-
HF6186	10929	HX4	-
HF6267	10927	-	W962/15
HF6326	10939	-	-
HF6360	10896	-	WD950/3
HF6553	10949	-	WH980/1
HF6554	10987	-	WH945
HF6555	10963	-	WH980/1
HF7541	10935	-	-
HF7569	10978	-	W1150/2
HF7968	10979	-	WD950/2
HF7901	10938	-	--
HF8084	10980	-	-
LF3315	10966	OC88	W940/37
LF3343	10967	-	W940/34
LF3345	10968	-	W940/34
LF3346	10969	OC35	W1170
LF3347	10920	OC14	W8005
LF3349	10951	-	W950/18
LF3360	10970	-	-
LF3402	10912	-	W940
LF3460	10894	-	W712/21
LF3467	10952	-	-
LF3468	10971	-	-
LF3481	10972	-	WP1144
LF3497	10940	-	W1140/2
LF3567	10973	-	W1254
LF3594	10942	-	WP1169
LF3703	10932	OC124	W925
LF3754	10974	-	HU947/2X
LF3783	10975	-	W1140/11
LF3819	10976	-	HU931X
LF4054	10919	OC60	W962



FILTRES FLEETGUARD



FLEETGUARD	DIFFUMAG	CORRESPONDANCE	
		MAHLE	MANN
LF4056	10918	OC26	W940/18
LF551A	10964	OC67	W940/1
LF580	10915	OC133	W1126
LF594	10910	OX50	H712K
LF673	10965	-	W950/17
LF678	10913	OC103	W936/4
LF680	10953	OC22	-
LF682	10911	-	W1140
LF699	10914	OC42	W950/7
LF700	10921	OC38	W723/3
LF701	10931	OC37	W940/24
LF708	10941	-	W950
LF742	10916	OC62	W930
WF2051	8896	WF1	-
WF2069	10946	WF1	WA940/6
WF2074	10948	-	WA940/7
WF2079	10947	-	-
WF2087	10956	-	-

**Pour d'autres références de la gamme FLEETGUARD,
n'hésitez pas à nous consulter.**

Tél 03 88 55 57 02



FILTRES A GASOIL



Réf. 7111/296
Filtre CAV modèle court



Réf. 7111/796
Filtre CAV modèle long



Réf. 7176/496
Filtre CAV modèle à visser

NOTES